

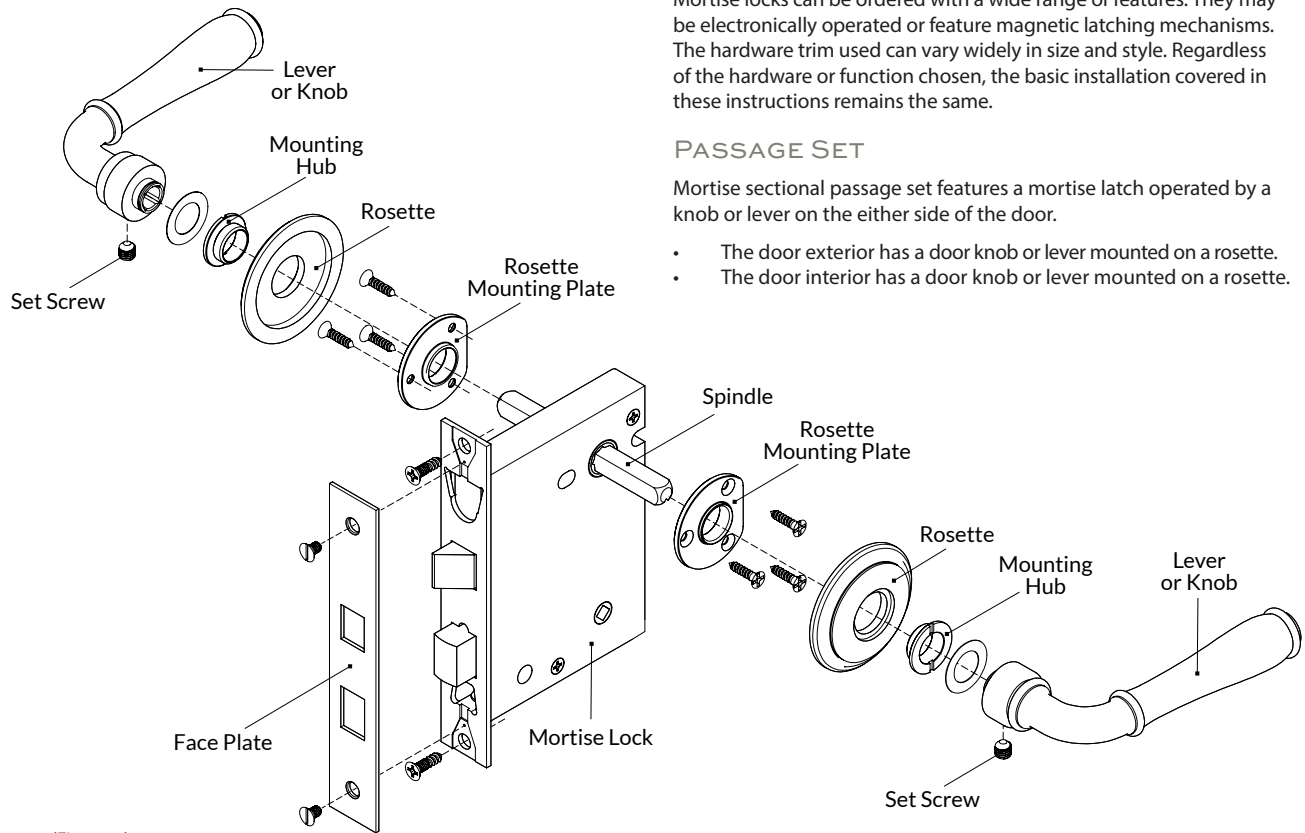

MS-PS - MORTISE SECTIONAL PASSAGE SET



(Figure 1)

Mortise locks can be ordered with a wide range of features. They may be electronically operated or feature magnetic latching mechanisms. The hardware trim used can vary widely in size and style. Regardless of the hardware or function chosen, the basic installation covered in these instructions remains the same.

PASSAGE SET

Mortise sectional passage set features a mortise latch operated by a knob or lever on the either side of the door.

- The door exterior has a door knob or lever mounted on a rosette.
- The door interior has a door knob or lever mounted on a rosette.

PREPARE DOOR

1. Prepare the door according to the template provided. If optional surface mount screws are to be used, use the escutcheon plates to mark the hole locations to drill pilot holes.

NOTE Different models of mortise locks may be used for a variety of applications. The proper door templates will be provided for the lock ordered. The lock depicted here may differ from the model you are installing.

INSTALL THE MORTISE LOCK

2. Insert the mortise lock body into the cavity and mark the lock screw locations. Drill pilot holes for the screws, then install the lock using the screws provided. Metal doors require two tapped holes for the combination screws. Confirm the screw size prior to drilling and tapping these holes. (Figure 2)

Do not install the lock face plate at this time.

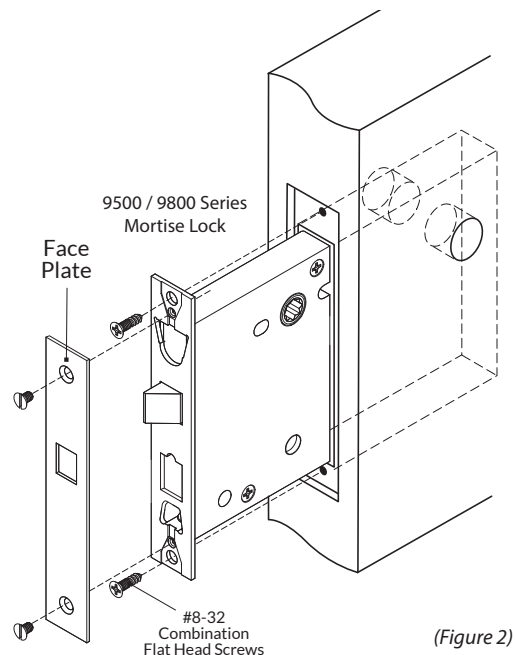

(Figure 2)



MS-PS - MORTISE SECTIONAL PASSAGE SET

ROSETTE MOUNTING PLATES

- Loosely install the threaded hubs into each rosette mounting plate. This will help with the alignment process.
- Center the alignment tool spindle into the lock hub, then position the rosette mounting plates on the door surface. Screw the alignment nuts onto the spindle so the tapered ends snug the mounting plates in place. Align the mounting plates so the flat edges are parallel to the door edge, then mark the screw hole locations. (Figure 3)
- Drill pilot holes for the mounting screws before installing the mounting plates. For metal clad doors, drill and tap these holes to accept #6-32 machine screws.
- Remove the alignment nuts and spindle and set aside for future installations.

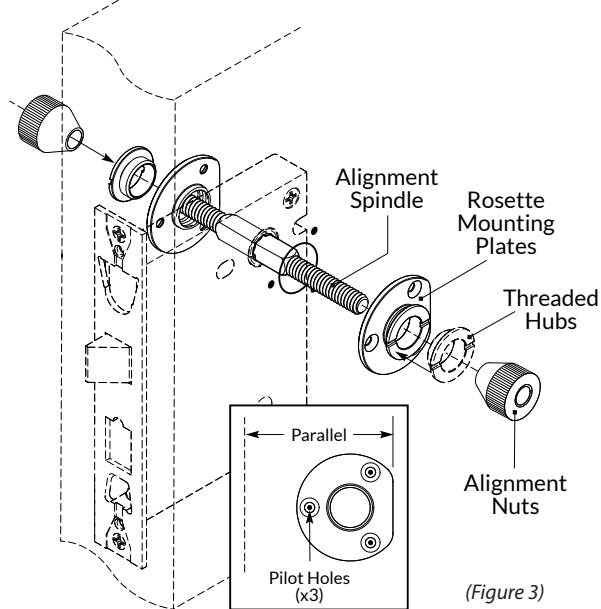

INSTALL SPINDLE

- Slide the spindle into the lock hub, centering in the lock body. Make sure the set screw groove is on the bottom, facing the floor. (Figure 4)

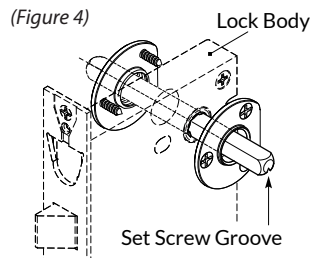

- Position the rosette mounting plates on the door and secure with the screws provided. Using a lever or knob on the spindle, check the latch function of the lock to assure smooth operation. If binding occurs, minor adjustment of the lock body or mounting plates may be necessary.

INSTALL ROSETTES

- Position a rosette over the mounting plate. Insert the mounting hub and tighten into the mounting plates with the rosette installation tool. Repeat on the other side of the door. (Figure 5)

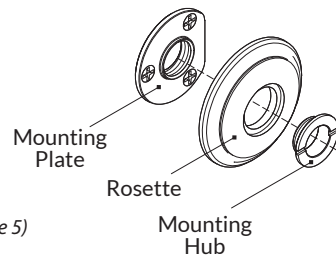

INSTALL LEVERS OR KNOBS

- Starting on the exterior side of the door, place nylatron washers over the spindle and mounting hubs. With the set screw facing the floor, slide both levers or knobs onto the spindle. Snug them up to the rosettes.
- Secure the knobs or levers to the spindle by firmly tightening the set screws with an Allen Wrench. (Figure 6)

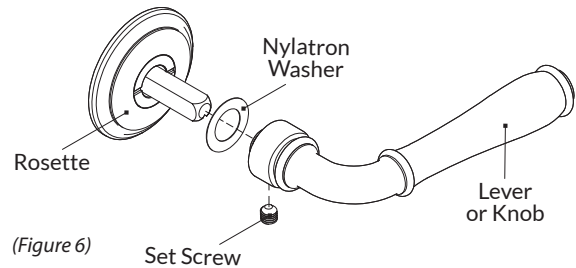

- Complete installation by attaching the latch face plate to the lock body (Figure 2)

MORTISE LOCK STRIKE PLATE

Depending on the lock model, function, and handing, the strike plate and dust box may appear differently than shown.

- Measure the jamb to determine the location the latch bolt strikes when the door is fully closed. Using the strike plate template provided, prepare the door jamb to accept the dust box and strike plate.

Note: Determine the handing required. Mortise the jamb accordingly.

- Install the dust box and face plate with the screws provided. Make sure the face plate sits flush with the jamb surface; deepen the cavities as needed. After installation, if the latch does not fully engage with the strike, loosen the screws and adjust. (Figure 7)

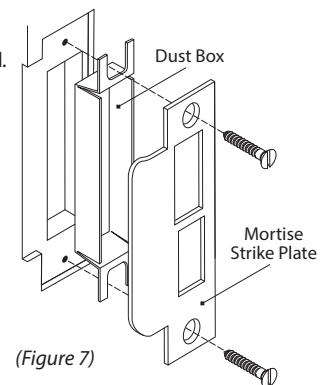

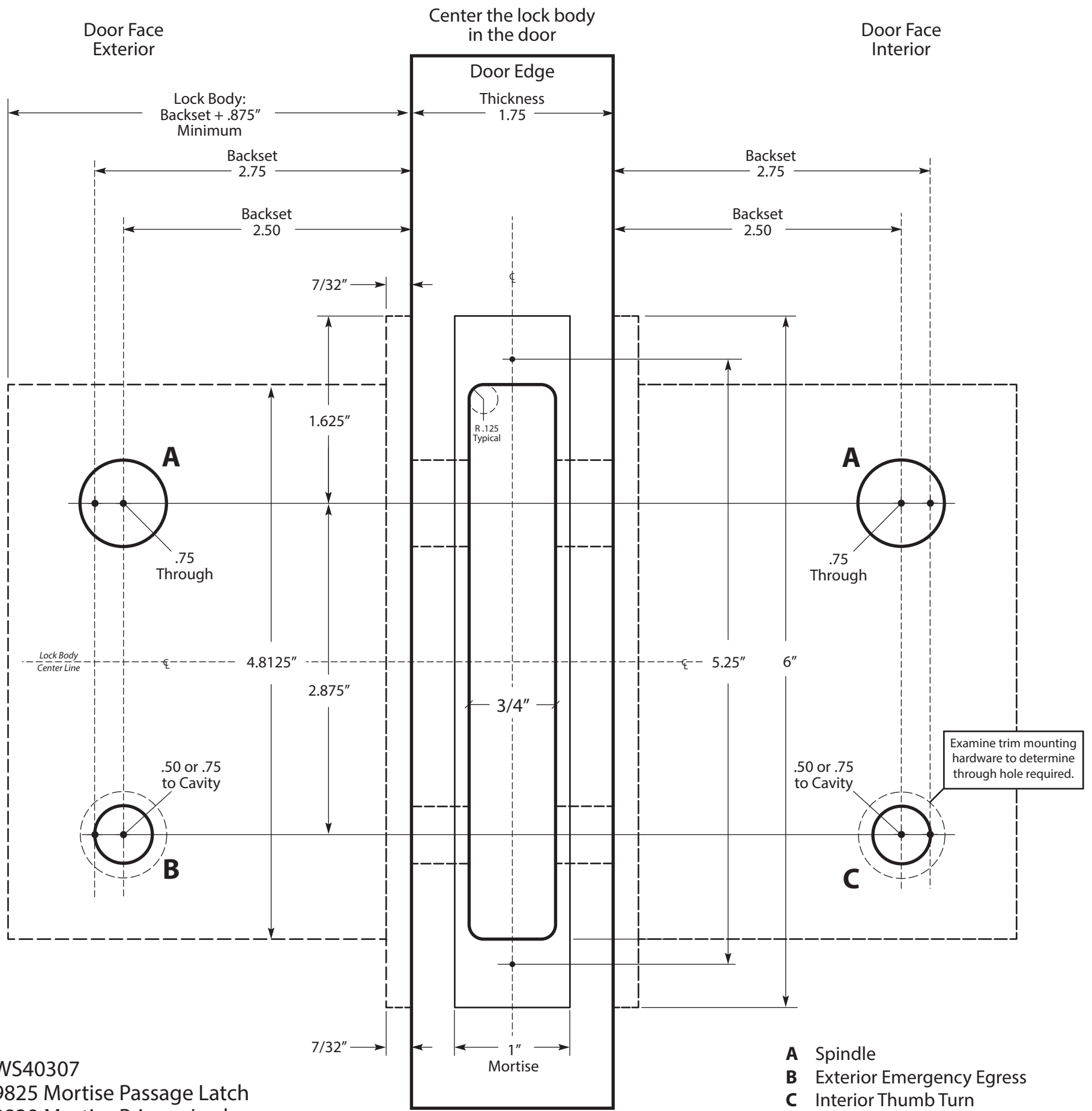

WS40307
9825 Mortise Passage Latch
9839 Mortise Privacy Lock

Proprietary And Confidential

© WSB Hardware, Inc. 2021

Any reproduction in part or as a whole without the written permission of Water Street Brass is prohibited.

Lock Functions

