



WATER STREET
BRASS

Thumb Piece Latch x Auxiliary Deadbolt Escutcheon Assembly Installation

PREPARE THE DOOR

These instructions are for the installation of a thumbpiece exterior by passage latch and an auxiliary deadbolt on an escutcheon plate.

1. If your door is not pre-drilled for the latch and auxiliary dead bolt, use the provided template for the bolt. Mark hole locations on the door.

Additional routing on the exterior side of the door will be necessary to accommodate the thumbpiece actuator assembly.

It is a good idea to lightly pencil a backset line on the interior side of the door, parallel to the door edge. Your spindle and deadbolt holes will all fall on this line.

2. Using the drill & bore sizes specified on the template, carefully drill the door. A minimum 1-5/8" cross bore is required to accommodate the toggle mechanism on the deadbolt.

INSTALL THE LATCH & ESCUTCHEONS

3. Install the latch body and face plate into the door and secure loosely with the screws provided. Do not tighten completely at this time. You will need to check alignment and function after it has been installed.

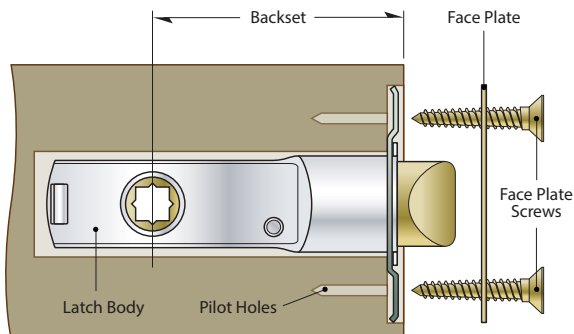

CHECK ALIGNMENT AND FUNCTION

4. Making sure the thumb piece is in the upright most condition, position the exterior plate assembly onto the door surface, sliding the spindle through the latch. Make sure the spindle **is centered in the latch body**. Check that the pocket for the thumb piece stem is deep enough and that it does not interfere with the movement of the mechanism.

Test the thumb piece operation and if binding occurs, you will need to remove the exterior plate and

unscrew the swivel spindle to a point that either side engages the latch hub independently.

5. Your entry handle will be held in place with two 1/4-20 through bolts. The upper bolt will be covered by the interior plate when installed. The access hole will need to be countersunk to a depth where the bolt head and re-enforcing grommet sit completely below the door surface. Install this bolt at this time.

6. Next, slide the interior plate assembly onto spindle. With both plates in place, test again that the latch does not bind. The interior knob/lever should operate the latch in the normal manner. On the exterior plate, the thumb piece activation mechanism will rotate the spindle and operate the latch.

Once satisfied that the alignment is proper, you can now tighten the face plate screws on the latch.

ATTACH THE PLATES TO THE DOOR

7. Install the lower through bolt through the bolt cover mounting plate and into the entry handle. Finish by hand tightening the bolt cover onto this plate.

8. Mark the surface screw hole locations. Punch and drill pilot holes for all the surface mount screws and carefully install the screws.

Using the Allen Wrench provided, tighten the set screws on the knob/lever firmly.

INSTALL THE DEAD BOLT

9. Install the dead bolt body with the plastic sleeve and face plate into the door and secure with the face plate screws provided.

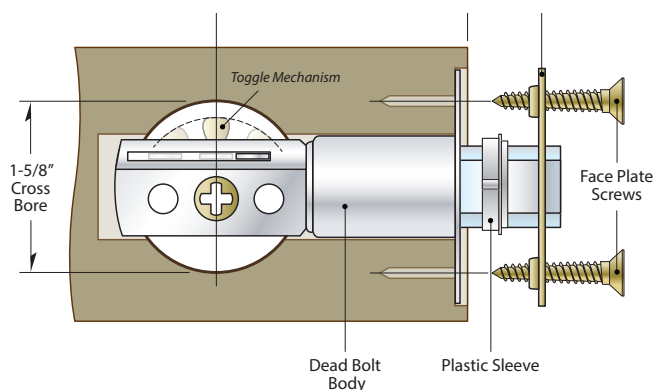



WATER STREET BRASS

10. Before installing the lock cylinder, the tailpiece will need to be cut to the proper length for the door thickness.

Use the scores on the tailpiece as a guide for cutting.

Cladding or other factors may alter the door thickness. Always measure and double check dimensions before cutting.

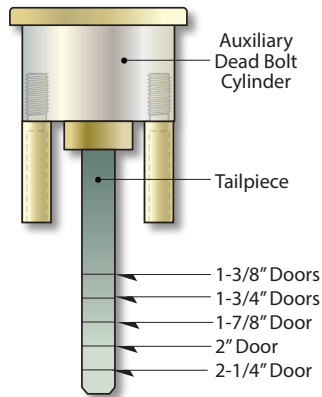

11. From the exterior side of the door, position the lock cylinder and the exterior blocking ring into the escutcheon plate. The tailpiece will slide through the dead bolt mechanism in the horizontal position.

Note: Doors under 1-3/4" thick will require two exterior blocking rings. This is necessary to provide clearance between the lock cylinder and the dead bolt body.

12. Assemble the interior mounting ring. Slide the actuator stem through the back of the mounting ring, position the retaining clip down onto the groove in the stem, then insert the two machine screws provided.

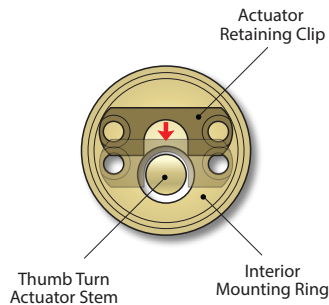

13. Position the interior mounting ring assembly into the interior plate. The cylinder tailpiece will slide into the back of the thumb turn actuator. Install the two machine screws into the cylinder mounting attachments and tighten firmly.

If there is any gapping or the screws do not tighten completely, there are two probable causes:

- The tailpiece is too long and needs additional trimming. See step 8.
- The screws are too long and they need to be cut down slightly.

14. Complete the installation by positioning the cover plate in the interior mounting ring. Position the thumb turn onto the actuator stem and firmly tighten the set screw.

DOOR JAMB

15. Carefully measure the jamb to determine the exact location that the lock bolt will land when the door is fully closed. Mark the location. Using the strike plate as a template, outline the shape and begin to mortise the door jamb 3/16" deep to accept the strike and security plate.

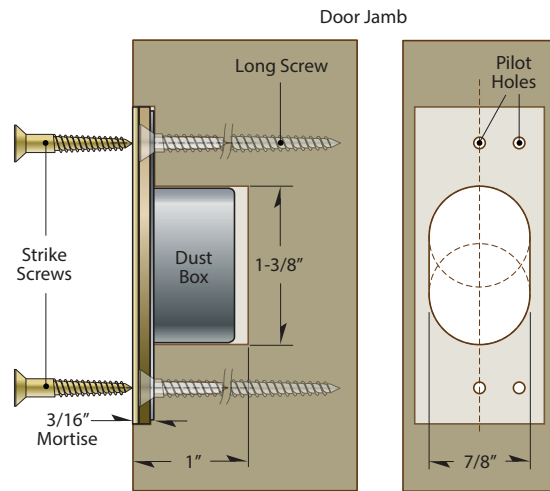

16. Mortise the dust box cavity as shown. Position the security plate in the jamb and mark the screw hole locations. Drill 1/8" diameter pilot holes for the screws.

Note The long screws should be positioned on the side of the plate closer to the center of the jamb.

17. Install the dust box and security plate. It will be helpful for you to trim the wings on the dust box so the long security screws pass through into the jamb and wall stud beyond.

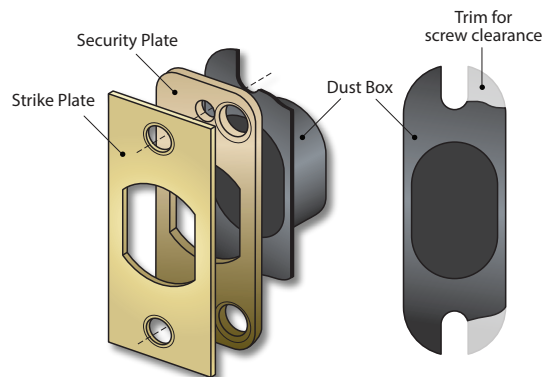

18. Finally, install the strike plate over top of the security plate, using the finished strike screws as shown.



WATER STREET BRASS

ASSEMBLY CROSS SECTION

